

Moorings 534PC

Specifications and Equipment List - **Moorings Upgrades In Bold**

SALOON/INTERIOR

- **Faux Leather “Macademia” upholstery**
- Laminate finishes with solid wood trims
- Saloon table
- Settee - L-shape
- Settee - two seater
- Wear resistant laminate flooring
- LED overhead lighting
- Stowage space under stbd settee cushions
- Front doorway access to foredeck
- **Interior saloon blinds - front & side windows**

GALLEY

- Staron galley worktop surfaces
- Single lever mixer faucet with pull out sprayer
- Single stainless steel sink - with water purifier
- Dish and cutlery drying recess with drainage
- Double door domestic fridge
- 4-burner hob
- Convection microwave oven
- Gas solenoid shut-off valve & warning light at cooker
- Gas detectors in each hull connected to alarm in saloon
- Gas cylinder regulator in dedicated LPG locker
- Separate garbage bin locker
- Stowage space in shelf lockers
- Spice rack
- 4 x Galley drawers
- 1 x Large overhead storage locker
- Smoke detector / alarm

NAVIGATION CONSOLE

- **Internal steering station with engine controls, steering wheel and autopilot control**
- LED overhead lighting
- Backrest stainless steel railing
- Storage locker under seat

CABINS x 4

- Laminate finishes
- Queen size berth (2025mm x 1720mm or 80" x 68")
- Bedside tables
- Headboard
- Hanging locker with lower shelf
- LED overhead lighting
- LED reading lamps
- Privacy blinds throughout
- Large open shelves
- Stowage drawers under bunk
- Large hull window incorporating portlight and pleated blind
- Transom windows with pleated blind (aft cabins only)
- Carbon monoxide detector / alarm
- **Full length mirrors**

FOREPEAKS

- Access from deck hatches only
- **Port forepeak includes:**
 - Mattress**
 - Air conditioning**
 - A/C electric outlet**
 - USB ports**
 - Fire Extinguisher**
- **Starboard forepeak includes:**
 - Basin with faucet & mirror**
 - Electric head with dedicated holding tank**
 - Shower with shower curtain and automatic sump drain**

HEAD COMPARTMENTS x 4

- Washbasin with basin mixer and Staron top
- Vanity locker with mirror
- Towel hook and rail
- Shower area with lever mixer and adjustable shower rose
- Shower sump with automatic drainage
- LED Overhead lighting
- Privacy blinds throughout
- **Electric freshwater flushing toilets**

PLUMBING INSTALLATION

- Hot and cold pressurized fresh water system consisting of:
 - 2 x Water tanks, 185USgal / 700ltr total capacity with level reading and gauges
 - 2 x Fresh water pressure pump with accumulator tank
 - 2 x Hot water cylinders 12USgal / 46ltr total capacity
 - Hot & cold stern shower**
- 4 x Automatic shower drain pumps
- Holding tanks, 45USgal / 170ltr total capacity
- 2 x Electric bilge pumps (keel sump) with float switches and alarm at switch panel
- 2 x Manual bilge pumps
- 2 x High water bilge float switches with alarm at switch panel
- 2 x Electric bilge pumps (engine room) with flat switch and warning light at switch panel
- Freshwater connection
- **Watermaker -- 31USgal / 117ltr per hr**
- **Deck wash fitting & pump. Triple wash- fresh/salt water system on foredeck & fresh water outlets on flybridge and aft cockpit**

DECK & HULL

- Stainless steel guard railing
- 2 x Stainless steel pushpits
- 2 x Pulpit seats (port & stbd)
- 1600w vertical windlass 10mm gypsy with hand held remote
- Anchor bow roller fitting for primary anchor
- Anchor bow roller fitting for secondary anchor
- Anchor chain stopper
- 1 x Chain locker
- 1 x Anchor/windlass locker
- 2 x Foredeck lockers
- Gas cylinder locker
- Sliding companionway door
- Hardtop over aft cockpit
- **Aft cockpit back shade curtains**
- **Large GRP aft cockpit table with 4 teak folding chairs**
- L-shaped settee in aft cockpit with cushions and bolster
- Sunbed in aft cockpit with cushions and bolster
- Swimming ladder
- Acrylic smoke grey tinted windows

EXHIBIT A

DECK & HULL Cont.

- Hatches:
 - 2 x Size 44 Flush Hatch over cabins
 - 2 x Size 60 Flush Hatch on foredeck (vented)
 - Portlights: 10 x Size 1 in hull side and transom
- Foredeck lounging area with watertight saloon access door
- 2 x Foredeck lounging cushions
- 2 x Drinks holders in aft cockpit
- 2 x Stainless steel coachroof handrails
- 2 x Stainless steel aft hardtop grab handles
- 1 x 330mm mooring cleat in anchor locker
- 10 x 300mm stainless steel mooring cleats
- **Moorings exterior pack (logos, striping)**
- **Winch type lifting platform with fixed chocks**
- **Fitted cushions in aft cockpit and foredeck loungers**
- **4 x Bean bag chairs**
- **4 x Stainless steel rod holders**
- **Stainless steel dive bottle rack - holds 4 bottles**

FLYBRIDGE

- Helm station console
- Staircase from aft cockpit to flybridge with LED courtesy lighting
- U-shaped upholstered settee
- Sunbed with mattress facing aft
- Wetbar unit with sink and faucet and Staron worktop
- **12V Refrigerator in flybridge wetbar**
- **Electric grill on flybridge wetbar**
- Life raft locker
- Stowage locker in wetbar
- Central fixed cocktail table with drink holder recess
- Guard railing around aft section of flybridge (stainless steel)
- Acrylic windscreen around fwd section of flybridge
- Hardtop over flybridge
- Hardtop supports
- **Flybridge enclosure front and sides only with aft sunshade curtain**
- Overhead lighting
- 2 x Pop-up lights
- Drinks holders

ENGINE & CONTROLS

- Double, electronic lever throttle / gearshift control
- Sound deadening panels in engine room
- 2 x Engine room ventilation fans and ducting
- 2 x Yanmar 350hp engines
- 2 x Propellers - 4-blade fixed
- 2 x Fuel deck fillers
- 2 x Fuel filter / water separators
- 2 x Composite fuel tanks 562USgal / 2130Ltr total capacity
- 2 x Exhaust skin fittings (stainless steel)
- 2 x Exhaust water locks
- 2 x Cooling water inlet strainers
- 2 x Exhaust cooling water temperature sensors with audible alarms at helm
- 2 x Moisture eliminating grilles
- **Bow thruster - fixed tunnel in port bow**

STEERING SYSTEM

- Balanced spade rudders in stainless steel
- Rudder stock in stainless steel
- Bearings with fiberglass rudder tube
- Hydraulic steering system
- Soft-grip steering wheel
- Compass at helm position

ELECTRICAL INSTALLATION

- **220V Isolated Shore Power - Includes 8kW isolation transformer with voltage booster function**
- **Includes 125/250V 50A shore power cable with stainless steel inlet, and AC switch panel**
- **Reverse Y shore power adapter**
- **Battery Charger - 12V 100A**
- **3000W 110V/60Hz inverter with region-specific outlet sockets with integrated USB's at specified locations**
- LED Courtesy lights at stairways
- LED Bi-colour & stern navlights
- 1 x 12v outlet sockets at helm station
- 2 x Double USB sockets at helm station
- 1 x Double USB socket in saloon
- 2 x Double USB sockets at nav desk
- 1 x Double USB socket in each cabin
- **Motorized TV lift in saloon**
- **42" TV**
- **6 x AGM house batteries**
- 4 x Engine starter batteries - 100Ah AGM type
- **Link engine starter batteries to house batteries**
- 1 x House battery isolator switch
- 2 x Engine starter battery isolator switches
- 2 x Alternators, standard with engines
- 1 x Electrical spares kit: fuses, relays, fuse holders
- 1 x Electric fog horn with control at helm station
- **Digital switching includes:**
 - **1 x Axiom 12" Multifunction Display at nav desk for digital systems switching**
- 3000W Inverter dedicated for convection microwave oven
- 1200W Inverter for refrigerator
- **Fusion Marine Stereo includes:**
 - **Docking station in saloon. Includes Bluetooth, USB & AUX connectivity. Fusion Marine speakers in saloon, aft cockpit, fwd cockpit & flybridge. Wired remote controls in fwd cockpit, aft cockpit & flybridge.**
- **Raymarine Base Pack includes:**
 - **VHF (Multizone with AIS receiver) at nav desk & additional VHF handset at helm.**
 - **Colour autopilot display.**
 - **Multifunction display at helm station with retractable depth transducer**
- **Rear-view Raymarine camera**
- **Forward facing Raymarine camera**
- **Ventilation fans in cabins**
- **Genset with individual start battery, gas water separator and control panel: Northern Lights 12kW supplied from port fuel tank. Fuel transfer ability from starboard to port tank.**
- **Chilled Water Air Conditioning:**
 - **70000BTU/h BLDC chiller unit.**
 - **1 x 30000BTU/h.**
 - **4 x 5000BTU/h air handlers with 5 x digital control panels.**
 - **Raw water and coolant circulation pumps.**
- **2 x Solar panels 150w each fitted to hard top**
- **2 x Underwater Lights. Blue, mounted in stern**

SAFETY EQUIPMENT

- 6 x Fire extinguishers
- **Safe with digital combination lock**
- Automatic extinguishing system for engine rooms
- Owner's Operating Manual
- CE Certification NMMA Certification

SAFETY GEAR

- 55lb (25kg) Stainless Steel DTX anchor with 230ft (70m) of galvanized chain
- 35lb (15kg) Britany anchor with 26ft (8m) of chain and 200ft (61m) warp
- Anchor bridle, shackles and hook
- 8 x Fenders
- 4 x Mooring lines
- 2 x Spring lines
- Life jackets per max pax
- Safety harnesses
- Life raft
- Flare Kit
- Binoculars
- Navigation tools: Parallel rule, compass, dividers

CRUISING GEAR

- Plates, cups, saucers, glasses per max pax
- Pots, pans, miscellaneous food prep tools
- Cooking and serving utensils
- Coffee pot, tea kettle, toaster

DELIVERY & COMMISSIONING

- Transport to Cape Town Harbor, launching, commissioning of equipment and sea trials
- Antifouling Paint
- Delivery from Cape Town to charter port

GENERAL SPECIFICATIONS

Length Overall (including platform):	16.19m / 53ft 1in
Length Overall:	15.40m / 50ft 6in
Beam:	7.67m / 25ft 2in
Draft:	1m / 3ft 3in
Displacement:	19857kg / 43777lb
Fuel Capacity:	2130ltr / 562USgal
Water Capacity:	700ltr / 185USgal
Engines:	2 x 350HP

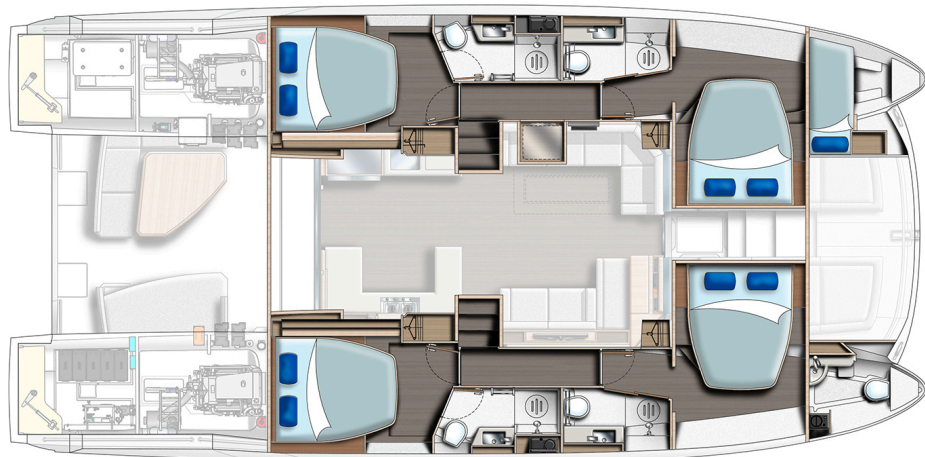

The Builder reserves the right to change or amend the contents of this document at any time without prior notification to any third party, and no liability will be accepted for errors contained within the same.

Initials

Initials