



# Moorings 403PC

3 cabins / 2 heads

**Specifications and Equipment List (Moorings upgrades in bold)**

Length Overall:	40ft   12.19m
Length Waterline:	39ft 7in   12.07m
Beam:	21ft 8in   6.61m
Draft:	3ft 7in   1.10m
Displacement:	30,488 lbs   13,829kg
Fuel Capacity:	370 USgal   1400 L
Water Capacity:	169 USgal   640 L
Engines:	<b>2 x Yanmar 320 hp</b>

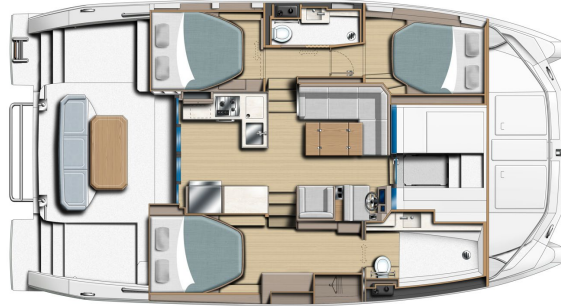

## DECK FITTINGS

- Guard railing (stainless steel)
- 2 x Pushpits (stainless steel)
- 2 x Pulpit seats (port & starboard)
- 1600w vertical windlass 10mm gypsy and capstan with hand-held remote
- Anchor bow roller fitting for primary anchor
- Anchor bow roller fitting for secondary anchor
- Anchor chain stopper
- 1 x Chain locker
- 1 x Anchor/windlass locker
- 3 x Foredeck lockers
- Gas cylinder locker
- Sliding companionway door
- Hardtop over aft cockpit
- Settee in aft cockpit with cushions and bolster
- Table in aft cockpit
- 2 x Folding deck chairs
- Swimming ladder
- Acrylic smoke grey tinted windows
- Hatches:
  - 2 x Size 44 flush hatch over cabins
- Portlights:
  - 5 x Size 1 in hull side
- Foredeck watertight access door to saloon
- 4 x Drinks holders in foredeck
- 2 x Coachroof handrails (stainless steel)
- 2 x Aft hardtop grab handles (stainless steel)
- 1 x 300mm mooring cleat in anchor locker
- 10 x 300mm stainless steel mooring cleats
- **The Moorings exterior pack**
- **Aft cockpit side and back shade curtains**
- **Foredeck cushions**
- **Rod holders**
- **Stainless steel dive bottle rack**
- **Custom stainless steel davit system with tackle & electric winch**
- **Stainless steel anchor and galvanized chain**
- **230ft (70m) anchor chain in lieu of 165ft (50m) chain**
- **Additional anchor c/w 26ft (8m) chain & 200ft (61m) warp**
- **Anchor bridle, shackles and hook**

## FLYBRIDGE

- Helmstation console
- **Flybridge enclosure front and sides only with aft sunshade curtain**
- Acrylic windscreen around forward section of flybridge
- Staircase from aft cockpit to flybridge with LED courtesy lighting
- U-shaped upholstered settee with backrests
- Storage under settee
- Wetbar unit with sink, faucet and Staron worktop
- **Electric grill on flybridge wetbar**
- **Refrigerator in flybridge wetbar - 12V**
- Central fixed cocktail table with drink holder recess
- Guard rail around flybridge (stainless steel)
- Hardtop over flybridge
- Hardtop support arch and forward support posts (stainless steel)
- Overheads LED spotlights
- Drinks holders
- Port Settee
- **Multifunction Display at Helm for digital systems monitoring (upgrade)**
- Compass at helm position

## SALOON

- Laminate finish
- Wear resistant laminate flooring
- Folding saloon table with two fixed legs
- LED overhead lighting
- Forward doorway access to foredeck
- Settee: L-shape on port side
- Internal helm
- Single Settee on starboard side
- Access to aft cockpit through sliding door
- **Silvertex "Macadamia" upholstery**
- **Interior saloon blinds - front & side windows**

## GALLEY

- Staron galley worktop surfaces
- Single lever mixer faucet with pull-out sprayer
- Single stainless steel sink
- Dish and cutlery drying recess with drainage
- Cover for drying recess
- Domestic refrigerator
- 3-burner gas hob
- **Convection microwave oven**
- Gas solenoid shut-off valve with control at switch panel & warning light at cooker
- Gas cylinder regulator in dedicated foredeck LPG locker
- Separate garbage bin locker
- Stowage space in shelf lockers
- Stowage space under floorboards
- 3 x Drawers
- Smoke detector / alarm
- LPG Detector/alarm

## INTERNAL HELM STATION

- Internal helm console - Includes steering and engine controls
- LED overhead lighting
- Helm seat with backrest
- **Multifunction display at internal helm (upgrade)**

## STARBOARD OWNER CABIN

- Laminate finish with solid wood trims
- Wear resistant laminate flooring
- Mattress Olympic Queen (1.6m x 2.00m or 5'3" x 6'7")

## Exhibit A

- 1 x Full height hanging locker
- 1 x Full height shelf locker
- Vanity table/desk with storage locker under lid
- Fold up vanity mirror
- Drawer unit with 4 x drawers
- Sliding entrance door with lock
- LED overhead lighting
- 2 x LED reading lamps over bunk
- Carbon monoxide detector / alarm
- **Full length mirror**

### OWNER CABIN HEAD

- Washbasins with basin mixer and Staron counter
- Under-basin locker with toilet roll holder
- Vanity locker with mirror
- Double towel rail
- Sliding heads door
- Dedicated trashcan locker
- Shower compartment with lever mixer and adjustable shower rose
- Shower sump with automatic drainage system
- Overhead LED lighting
- **Electric toilet**

### PORT FORWARD AND AFT CABINS

- Laminate finish with solid wood trims
- Wear resistant laminate flooring
- Double berths:
  - Forward Cabin - Queen (1.5m x 2.00m or 4'11" x 6'7")
  - Aft Cabin - Olympic Queen (1.6m x 2.00m or 5'3" x 6'7")
- Hanging locker with lower shelf
- LED overhead lighting
- 2 x LED reading lamps in each cabin
- Large open shelves
- 2 x Stowage drawers under bunk in forward cabin only
- 1 x Stowage drawer under bunk in aft cabin only
- Large hull window incorporating portlight with slatted blind
- Carbon monoxide detector / alarm
- **Full length mirrors**

### PORT HEAD

- Washbasins with basin mixer and Staron counter
- Under-basin locker with toilet roll holder
- Vanity locker with mirror
- Double towel rail
- Sliding heads door
- Dedicated trashcan locker
- Shower compartment with lever mixer and adjustable shower rose
- Shower sump with automatic drainage system
- Overhead LED lighting
- **Electric toilet**

### ENGINES & CONTROLS

- Electronic double lever throttle / gearshift control
- Sound deadening panels in engine room
- 2 x Engine room ventilation fans and ducting
- **Yanmar 320hp engines in lieu of standard 250hp engine**
- 2 x Propellers - 4 -blade fixed
- 2 x Fuel deck fillers
- 2 x Fuel filter / water separators
- 2 x Fuel tanks 185USgal / 700 L capacity each
- 2 x Exhaust skin fittings stainless steel

Initials: \_\_\_\_\_

Initials: \_\_\_\_\_

Rev: 12-14-2023

Exhibit A

- 2 x Exhaust water locks
- 2 x Cooling water inlet strainers
- 2 x Exhaust cooling water temperature sensors with audible alarms at helm

**ELECTRICAL INSTALLATION**

- LED Courtesy lights at stairways
- Bi-colour & stern navlights
- 12v DC switch panel
- 12v socket at switch panel and at helm station
- 1 x Double USB outlet at flybridge helm station
- 1 x Double USB outlet at internal helm station
- 1 x Double USB outlet in each cabin
- 1 x Wireless mobile phone charger in saloon
- 2 x House batteries
- 2 x Engine starter batteries
- **AGM batteries in lieu of standard and increased battery capacity**
- **Battery management system**
- 1 x House battery isolator switch
- 2 x Engine starter battery isolator switches
- 2 x Alternators, standard with engines
- 1 x Electrical spares kit: fuses, relays, fuse holders
- 1 x Electric fog horn with control at helm station
- Inverter for refrigerator
- **Stereo system with interior and exterior speakers**
- **Full Raymarine electronic package**
- **Rear-view camera**
- **Forward facing camera**
- **110V or 220V Shore power pack: Includes 2 port and 2 starboard shore power inlets with 2 x heavy duty shore powerlines, AC switch panel, AC outlets in cabins, galley, at internal helm station & switchpanel**
- **Inverter/battery Charger**
- **Sterling alternator to battery charger. Includes button on MFD at helm to link engine batteries to house batteries**
- **Genset**
- **Airconditioning**
- **Watermaker**
- **TV**
- **Solar panels**
- **Underwater lights**
- **Safe with digital combination lock**
- **Fans in the cabins**

**PLUMBING INSTALLATION**

- Hot and cold pressurized fresh water system consisting of:
- 2 x Water tanks, 170USgal / 640 L total capacity with level monitoring
- 2 x Fresh water pressure pump with accumulator tank
- 1 x Hot water cylinders 10USgal / 40 L total capacity
- 2 x Automatic shower drain pumps
- 2 x Holding tanks
- 2 x Electric bilge pumps (keel sump) with float switches and alarm at switch panel
- 2 x Manual bilge pumps (keel sump)
- 2 x High bilge float switches with alarm at switch panel
- 2 x Electric bilge pumps (engine room) with float switch and warning light at switch panel
- Freshwater deckfill
- Water purifying filter system
- **Deck wash fitting & pump - dual fresh/salt water system**
- **Stern shower: Hot/cold water**

**RUDDER & STEERING SYSTEM**

- Balanced spade rudders
- Rudder stock in stainless steel
- Self-aligning bearings with fiberglass rudder tube
- Hydraulic steering system with tilting steering wheel
- Soft grip steering wheel

**GENERAL EQUIPMENT**

- **Mooring / dock lines / fenders**
- **Safety pack**
- **Charter pack**
- **Commissioning and delivery to charter base**

**NOTE**

The Builder reserves the right to change or amend the contents of this document at any time without prior notification to any third party, and no liability will be accepted for errors contained within the same.