

# Moorings 52.4

## Specifications and Equipment List

### Moorings Charter Upgrades in BOLD

Length Overall: 50ft 7in   15.43m
Waterline Length: 47ft 8in   14.52m
Beam: 15ft 9in   4.8m
Draft: 6ft 4in   1.92m
Fuel Capacity: 106 US Gal   400 L
Water Capacity: 106 US Gal   400 L
Engine: 110 hp

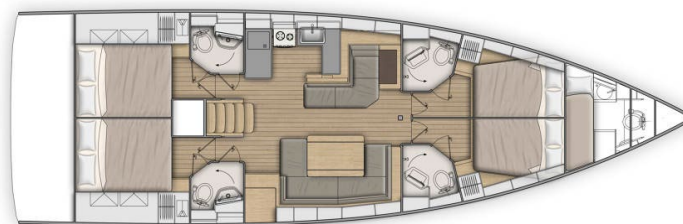

### CONSTRUCTION

- Vacuum infused hull (GRP / Sandwich balsa wood)
- Vacuum infused structural inner liner (Fabrics - resin) bonded to the hull
- Injected deck construction in glass fiber and Saerform foam sandwich, covered with non-slip diamond pattern
- **Shallow cast iron keel**
- Twin rudders hung with stainless steel stock
- **White coloured hull - The Moorings graphics**
- 8 Hull portholes

### DECK EQUIPMENT

- **Classical aluminum mast**
- Anodised aluminum boom
- Discontinuous stainless steel standing rigging
- Split backstay
- Rigid boom vang with tackle
- Self-tacking jib with on-deck furler
- 2 Stand Up mainsheet blocks on the coachroof
- 1 Self-tacking jib track with traveller
- All lines brought back to the helm stations (except boom topping lift and genoa halyard)
- Complete running rigging: Mainsail halyard, Genoa halyard with onmast tensioner, Boom topping lift with cleat on mast, Mainsheet, 1 Self-tacking jib sheet
- 6 Clutches
- Halyard covers
- 2 Flag halyards
- **1 Port electric primary winch - H46.2 STAEH (in lieu of standard)**
- **1 Starboard electric primary winch - H46.2 STAEH (in lieu of standard)**
- 1 Winch handle
- 2 Winch handle holders
- **Custom heavy duty battened charter mainsail**
- **Charter upgrade, heavy duty furling genoa with UV protection strips**
- **Profurl genoa furler**
- **Stackpack LazyJack system in Moorings blue with logo**
- Self-draining chain locker - Clench bolt - Hatch cover
- Single roller stainless steel bow fitting with offset roller
- **Additional anchor roller**

- **Bow stainless steel protection**
- 12 V - 1 500 W vertical electrical windlass - Remote control
- **Windlass control in cockpit with chain counter**
- 6 Aluminum mooring cleats
- 1 Open stainless steel pulpit
- 2 Stainless steel pushpits
- 2 Stainless steel handrails on coachroof
- **Outboard engine bracket**
- 1 Lifebuoy support bracket
- Welded ring on pushpit for flag
- **Custom double guard lines and stainless steel stanchions**
- Emergency ladder on pushpit
- Self-draining cockpit
- 2 Watertight lockers under the cockpit benches
- 1 Locker in cockpit bottom
- 1 Gas compartment under port helmsman seat
- Natural solid wood slatted cockpit benches
- Natural solid wood slatted helm seats with starboard storage locker
- Foldaway helmsman foot chock
- 2 Steering wheel consoles
- 2 Deck access for emergency tiller
- 1 Emergency tiller
- 1 Steering compass on the cockpit table
- Engine throttle and control panel
- **"Luxe" cockpit table upgrade**
- 1 Cockpit shower with mixer tap
- Fully opening transom, convertible to bathing platform (electrically operated)
- Intermediate cockpit access step
- Natural solid wood decking on swim platform
- **Large swimming ladder attached to the aft platform (in lieu of standard)**
- **Aft transom protection**
- **2 Companionway sunbeds**
- **Stainless steel anchor and galvanized chain**
- **Bimini and dodger**

## SALOON

- **Light oak woodwork with charcoal material panelling**
- Laminated floorboards
- Wooden saloon companionway with moulded wood suspended steps
- **Specific non-slip surface on the companionway steps**
- 2 Stainless steel handrails covered with anthracite leather
- U shaped saloon bench
- **Custom upholstery**
- **Saloon table converts to double berth**
- Storage under bench seats
- Bottle rack behind the bench against the forward bulkhead
- Panoramic coachroof windows with curtains
- Hull portholes
- Opening portlights with curtains in the coachroof side window
- Opening deck hatches with mosquito screen/blinds
- Chart table with storage- moulded wood fiddle - Laminated covering
- Seat with backrest, lounge function
- Electrical panel
- 1 Flexible and swivelling reading light
- USB socket

- **Additional mirror in the saloon**
- **Blinds in the saloon**
- **LED indirect lighting**

## GALLEY

- U-shaped galley
- Work top in Clay compact with Corian fiddles
- 1 rectangular stainless steel sink - 1 Mixer tap with hot/cold water under pressure
- 1 Gas cooker 2 burners - Stainless steel oven on gimbal - Stainless steel protection handrail
- 1 Ice box
- **Refrigeration system for the ice box (12 V)**
- **Drainage for the ice box**
- 1 Refrigerator (12V), front opening
- Fitted lockers and closed shelving
- Bin with access on the work top
- 1 Lower unit: 3 Drawers
- **Microwave**

## 2 SYMMETRICAL AFT CABINS

- 1 Double bed
- Hanging locker - Cupboard - Closed shelving
- 1 Bed access sideboard
- 2 flexible and multi-directional reading lights at bedhead
- 1 USB socket
- 1 Hull porthole with sliding blind
- 1 Cockpit opening window with curtain under cockpit seats
- 1 Fixed cockpit window with curtain on the coaming
- **Additional opening porthole for improved ventilation**
- **Mosquito screens on portholes**

## 2 SYMMETRICAL AFT HEADS

- Access from the saloon or the aft cabin
- 1 Shower area accessible by swivelling the washbasin
- **1 Electric toilet**
- 1 80 L / 21 US Gal rigid holding tank
- 1 Mirror
- Toilet accessories
- 1 Opening portlight

## 2 SYMMETRICAL FORWARD CABINS

- 1 Double bed
- 1 Hanging locker - 2 Closed high shelves, 1 Open shelving
- 1 Drawer under the bed
- 2 Swivelling reading lights
- 1 Deck hatch with mosquito screen/blind
- 1 Hull porthole with sliding blind
- 1 USB socket
- Access door to the head

## 2 SYMMETRICAL FORWARD HEADS

- **1 Electric toilet**
- 1 Polyester basin with mixer tap
- 1 Cabinet with mirror
- Toilet accessories

## FOREPEAK CABIN

- **Access through deck hatch - Stainless steel ladder**
- **1 Bed (2m x 0,66m / 6'7" x 2'2") Foam mattress - PVC cover**
- **2 Storage lockers, Under the bed - Cupboard and shelves**
- **Electric toilet**
- **Rigid holding tank (50L / 13 US Gal)**
- **Washbasin - Mirror - Shower head mixer tap - Shower tray with curtain**
- **1 LED ceiling light, 1 LED reading light**

## ENGINE

- **Yanmar 110HP**
- Engine throttle and control panel on starboard
- Engine compartment: Soundproofing foam - Ventilation: 3 air intakes and 1 forced air outlets
- 1 Alternator 12 V / 125Ah
- 1 Rotomoulded diesel tank 200 L / 53 US Gal (under starboard aft berth) - Electronic gauge - Low level alarm - 1 Deck filler
- **Extra fuel capacity (200L / 53 US Gal)**
- Filters: Seawater - Diesel - Water separator
- Fixed three blades propeller
- 1 Engine access through companionway (opening with 2 gas struts) - 2 Engine access through aft cabins
- **Bow thruster**

## ELECTRICAL INSTALLATION

- **Full 110V or 230V system**
- 12V circuit
- **AGM batteries in lieu of standard & increased battery capacity**
- **Battery charger**
- **Navicolor monitoring system**
- 1 Power distributor
- 12 V Electrical panel (Fuses - Voltmeter - Water gauge - Fuel gauge - Battery warning - Fuel warning - Water warning)
- 6 110V or 230V Sockets
- 6 USB sockets
- 1 Shore power socket
- **Support bracket for shore power cables**
- LED lighting: Overhead lights - Reading lights - Reading light, flexible and multi-directional
- LED navigation lights: 1 Masthead light - 1 Steaming light - 1 Anchor light on masthead
- **Fans in the saloon and the cabins**
- **Underwater light**
- **Generator**
- **Watermaker**
- **Air conditioning throughout including bow cabin**
- **Inverter**
- **TV in the saloon**
- **Stereo system with interior and exterior speakers**
- **Full B&G electronic package**
- **Solar panel**
- **Electronic safe**

## PLUMBING

- 1 Rotomoulded freshwater tank 400 L / 106 US Gal, under berth in forward cabin - 1 Deck filler
- Pressurised electric water pump - Expansion tank - Inline filter
- 40 L / 11 US Gal Electric water heater (engine use)
- 1 Rigid 80 L / 21 US Gal black water holding tank for each aft and forward head
- Electrical shower drain pumps
- 1 Electric bilge pump
- 1 Manual bilge pump

- 1 Electric pump for the ice box drain

## **GAS**

- 1 Box for 2 gas bottles in the cockpit
- Regulator and safety tap
- Gas leak detector
- **Enhanced safety gas system**

## **GENERAL EQUIPMENT**

- **Mooring / dock lines / fenders**
- **Safety pack**
- **Charter pack**
- **Commissioning and delivery to charter base**

## **NOTE**

The Builder reserves the right to change or amend the contents of this document at any time without prior notification to any third party, and no liability will be accepted for errors contained within the same.