



# Moorings 44.4

4 Cabins / 4 Heads

## Specifications and Equipment List (Moorings charter upgrades in bold)

Yacht Model:	Dufour 44
<b>Length Overall:</b>	<b>45ft 7in   13.91m</b>
Hull Length:	42ft 11in   13.10m
Beam:	14ft 7in   4.45m
<b>Draft:</b>	<b>5ft 3in   1.60m</b>
Fuel Capacity:	66 US Gal   250 L
Water Capacity:	66 US Gal   250 L
<b>Engine:</b>	<b>Yanmar 57 HP</b>

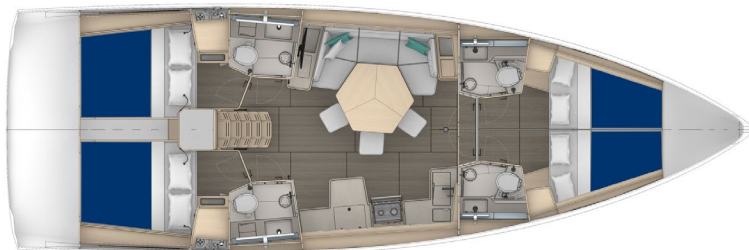

## CONSTRUCTION

- Hull: Infused polyester/glassfibre
- Gelcoat: NPG Gelcoat with first layer impregnated with vinylester resin forming an optimum barrier against osmosis
- Structure: Inner moulded hull bottom, structural framing laminated to the hull
- Deck: Sandwich with injected core
- Ballast: Keel bolts reinforced by stainless steel backing plates
- Rudder: Semi-elliptical shape, filled with closed-cell epoxy foam
- Rudder stock: Solid stainless steel
- Non-slip deck surface: Diamond point non skid profile on deck
- **Decoration: Moorings graphics**
- **Shallow cast iron keel**

## DECK

- **Stainless steel roof handrails**
- Anchor locker: Self-draining with anchor chain eyebolt
- Bow pulpits: Stainless, opened for easy access
- Stern pushpit: Lifebuoy bracket and opening life-lines with hook
- Stanchions: With 2 rows of life-lines
- **Fixed bowsprit**
- **Stainless steel bow protection**
- **Lifeline gates and fender step**

## DECK FITTINGS

- Shroud chainplates: Outboard deck side shroud chainplates
- **Stainless steel cleats**
- Mooring line protection: 6 stainless steel plates, on hull sheer line
- Fuel deck fillers: 1
- Water deck fillers: 1
- **Rigid boom vang**
- Deck organisers: 4-sheave deck organiser for halyard, sheet, and reef line returns : 1 portside and 1 at starbord
- Cleats: 2 x 4 jam cleats port side and starboard side of the companionway
- Furler line jamcleats: 1 at aft end of sidedeck
- **6 winches (including 3 electric winches)**
- **Reefing line system leads back to the roof**

- **Stainless steel anchor and galvanized chain**
- **Stainless steel exhaust**
- **GRP cover**

## COCKPIT

- Lockers: 2 large side lockers on starboard and portside
- **Helm: Twin helm position with stainless steel wheels**
- Helm console: Polyester POD and aluminium columns
- Engine control: Engine controls on side of cockpit and control panel on pod
- Compass: 1 compass on port helm position
- Instrumentation: On starboard and portside helm
- Gas locker: locker aft, to port
- Liferaft locker: Locker in transom
- Shore supply: Portside
- Bathing ladder: Foldaway stainless steel bathing ladder
- Cockpit floor: Non-slip polyester cockpit floor
- Emergency tiller: Head of rudder stock beneath helmsman's floor for fitting the emergency tiller
- **Cockpit table**
- **Bimini and dodger**
- **Starboard and Portside helm console instrument support pods**
- **Cockpit shower (cold/hot)**
- **Aft bathing platform**
- **Transom protection**
- **2 inflatable backrests for helmseat position**
- **Cockpit cushions (seat and backrest)**
- **Helmsman seat cushion**
- **Teak on seats**
- **Plancha and sink**
- **Cockpit portlight in aft starboard cabin**
- **Cockpit portlight in aft port side cabin**
- **Davit system**

## RIGGING & SAILS

- **Moorings enhanced mast: anodized aluminium with 2 levels of swept spreaders**
- Mast stepping: On deck
- Lights: 3-colour masthead light + anchor light + steaming light
- Topping lift: Boom topping lift cleat
- Boom: Anodized aluminium fitted with 2 continuous reefers
- Standing rigging: Continuous in stainless single-strand cable, chrome-plated bronze rigging screws, comprising: forestay, inner and lower shrouds
- Backstay
- Running rigging: Running rigging in pre-stretched textile including: main and genoa halyards, boom topping lift, main and genoa sheets, 2 continuous reef lines, leech tensioner, furling line, downhaul tackle
- **Custom heavy duty battened charter mainsail**
- **Charter upgrade, heavy duty furling genoa with UV protection strips**
- **Stackpack LazyJack system in Moorings blue with logo**
- **Profurl genoa furler**
- **Mainsail bridle on coachroof**

## INTERIOR

- Woodwork: Real wood veneer
- Floors: Moabi laminated
- Doors: cabin doors can be secured in the open position
- Head-liner: painted head-liner
- **Signature ambiance**

- **Grey faux-leather upholstery**

## GLAZING & LIGHTING

- Hull: 10 hull windows
- Side Coachroof: 6 fixed ports and 2 openable
- Coachroof hatches: 1 size 44 and 2 size 20
- Deck panel : 1 size 60 and 2 size 44 + 1 skylight
- Lighting: Numerous downlights and reading lights
- **Blinds with mosquito screens on deck hatches**
- **LED interior lights**

## COMPANIONWAY

- Steps: Wide steps
- Engine cover: Hinged wooden engine cover with 2 gas struts
- Hand rails: 2
- Wine cellar
- **Custom companionway door**

## 2 FORWARD CABINS

- 1 double bed
- Mattress: 14 cm thick foam mattress with washable cover
- Stowage:
  - Below berth
  - Cupboard
- Upholstery headboard
- Reading lights + indirect lighting
- Access: To sounding and speed transducers
- Access: To windlass

## 2 FORWARD HEADS

- Wash-basin: synthetic resin
- Water: Hot and cold water
- Large mirror
- Cupboards: Storage unit
- **1 Electric toilet**
- **Automatic shower pump**

## 2 AFT HEADS

- Wash-basin: Basin unit with tap
- Water: Hot and cold water
- Large mirror
- **1 Electric toilet**
- **Automatic shower pump**

## SALOON

- Living room bench: Large seats
- **Saloon table convertible into berth**
- Storage under seats and behind backrests
- Mast foot

## GALLEY

- Worktop: synthetic resin
- Sink: Stainless twin-bowl sink with covers in synthetic resin
- Water: Hot and cold pumped water brass single-lever mixer tap
- **Gas cooker: 2-burner gas cooker with oven on gimbals, with stainless rail**

## Exhibit A

- Crockery storage: Dowels to retain crockery when heeling
- Cooler compressor 12V
- Refrigerator access: Via the worktop and front access
- Stowage:
  - 2 closed cubby-holes
  - Below sink
  - Under floor
- Waste bin
- Other: Light and ventilation ensured by opening port-lights and LED strips over galley
- **Microwave oven (110V or 220V only)**
- **Additional fridge**

## AFT CABINS

- 1 double bed on port and starboard
- Mattress: 12 cm thick foam mattress with washable cover
- Fuel tank: Beneath starboard
- Water tank: Beneath port berth
- Stowage: Hanging locker
- Soundproofing: Double bulkhead provides acoustic and thermal insulation from adjoining engine compartment
- Technical area: Battery isolators on side of berth
- **Mattress cover**

## ENGINE

- **Engine: Yanmar 57 HP**
- Transmission: Sail-drive
- Cooling system: Heat exchanger, anti-siphon valve
- Tank: Gauge on electrical distribution panel
- Fuel filter: Fuel filter with water separator
- Shut-off valve: Emergency fuel shut-off valve
- Control panel: Control panel close to helmsman, with hour meter and tachometer
- Alternator: Alternator with battery isolator
- Ventilation: Ventilation with 1 natural inlet and electric mechanical extract
- Bilge: Independent engine bilge
- Access: Access to the engine from front and both sides
- **Propeller: 3-blade propeller, fixed**
- Insulation: Carefully-designed foam acoustic and thermal insulation
- **Rope cutter on Sail Drive**
- **Bow thruster**

## PLUMBING

- Water tanks: 1 polyethylene water tank with inspection holes and gauges
- Electric bilge pump: With strainer, controlled from electrical distribution panel
- Manual bilge pump: Operated from cockpit
- **Hot water tank: Pressurized water pump unit and water-heater via heat-exchanger**
- Other: Access to strainer via floor trap
- **Water purifier**
- **Watermaker**

## ELECTRICITY

- Circuit: 12 V
- Distribution panel
- Isolator: 1 per battery set in aft port cabin
- **2000W inverter**
- **Shore power pack**
- **USB outlets in the cabins**

- **Increased battery capacity and AGM batteries in lieu of standard**
- **Battery charger**
- **LED navigation lights**
- **Electric windlass 2000W**
- **Full B&G electronic package**
- **Solar panels**
- **Stereo system with interior and exterior speakers**
- **Induction chargers in aft cabin**
- **Generator**
- **Air conditioning**
- **TV**
- **AIS (transmitter/receiver)**

#### **GENERAL EQUIPMENT**

- **Mooring / dock lines / fenders**
- **Safety pack**
- **Charter pack**
- **Commissioning and delivery to charter base**
- **Custom antifouling**

#### **NOTE**

The Builder reserves the right to change or amend the contents of this document at any time without prior notification to any third party, and no liability will be accepted for errors contained within the same.